



# HF-Performer II Xtreme for TL5/TL-D lamps

## HF-P Xt 254 TL5 EII 220-240V 50/60Hz

Enhance the quality of applications with robust driver technology HF-Performer Xtreme is a unique X-technology from Philips that guarantees the longest lifetime and highest reliability under the harshest conditions. The ballast is primarily designed for Indoor application. For outdoor application, the luminaire should be minimum Class II need to be sufficiently protected against water & dust. The installation should also be guard against any lightening surge or any other necessary electrical protection as deemed in such typical installation & application.

### Product data

General Information	
Application Code	EII
Type Version	mk1
Lamp Type	TL5
Number of Lamps	2 piece/unit
Number of Products on MCB (16A Type B) (Nom)	12
Automatic Restart	Yes
Operating and Electrical	
Input Voltage	220 to 240 V
Input Frequency	50 to 60 Hz
Operating Frequency (Min)	42 kHz
Ignition Method	Warm Start
Crestfactor (Max)	1.7
Power Factor 100% Load (Nom)	0.96
Ignition Time (Max)	2.0 s
Mains Voltage Performance (AC)	-8%+6%
Mains Voltage Safety (AC)	-10%+10%

Earth Leakage Current (Nom)	0.5 mA
Inrush Current Width	0.310 ms
Constant Wattage Deviation	-2%/+2%
Ballast Factor (Nom)	1.00
Power Losses (Nom)	9.5 W
Inrush Current Peak (Max)	33 A
Wiring	
Connector Type Input Terminals	WAGO 251 universal connector [ Suitable for both automatic wiring (ALF and ADS) and manual wiring]
Cable Capacity Output Wires Mutual (Nom)	200 pF
Connector Type Output Terminals	WAGO 251 universal connector [ Suitable for both automatic wiring (ALF and ADS) and manual wiring]
Wire Striplength	8.0-9.0 mm
Input Terminal Cross Section	0.50-1.00 mm <sup>2</sup>
Output Terminal Cross Section	0.50-1.00 mm <sup>2</sup>

## HF-Performer II Xtreme for TL5/TL-D lamps

Auto Insert (ALF/ADS) Wire Cross Section	0.5 mm <sup>2</sup>
Cable Capacity Output Wires to Earth (Nom)	200 pF
<b>System characteristics</b>	
Rated Ballast-Lamp Power	54 W
Rated Lamp Power on TL5	54 W
System Power on TL5	63.5 W
Lamp Power on TL5	54 W
Power Loss on TL5	9.5 W
<b>Temperature</b>	
T-Ambient (Max)	60 °C
T-Ambient (Min)	-25 °C
T-Storage (Max)	80 °C
T-Storage (Min)	-25 °C
T-Case Lifetime (Nom)	75 °C
T-Case Maximum (Max)	75 °C
T-Ignition (Max)	60 °C
T-Ignition (Min)	-25 °C
<b>Mechanical and Housing</b>	
Housing	L 360x30x28
<b>Emergency Operation</b>	
Battery Voltage Lamp Ignition	198 V
Battery Voltage Lamp Operation	176-254
<b>Approval and Application</b>	
Energy Efficiency Index	A2

IP Classification	IP 20 [ Ingress Protection 20]
EMI 9 kHz ... 30 MHz	EN55015
EMI 30 MHz ... 1000 MHz	EN55022 level B
Safety Standard	IEC 61347-2-3
Performance Standard	IEC 60929
Quality Standard	ISO 9000:2000
Environmental Standard	ISO 14001
Harmonic Current Emission Standard	IEC 61000-3-2
EMC Immunity Standard	IEC 61547
Vibration Standard	IEC68-2-6 F c
Bumps Standard	IEC 68-2-29 Eb
Humidity Standard	EN 61347-2-3 clause 11
Approval Marks	CE marking ENEC certificate VDE-EMV certificate
Temperature Marking	Yes
Emergency Standard	IEC 60598-2-22
Hum And Noise Level	Inaudible

### Product Data

Full product code	871150091431630
Order product name	HF-P Xt 254 TL5 EII 220-240V 50/60Hz
EAN/UPC - Product	8711500914316
Order code	913700630066
Numerator - Quantity Per Pack	1
Numerator - Packs per outer box	12
Material Nr. (12NC)	913700630066
Net Weight (Piece)	0.360 kg

### Dimensional drawing

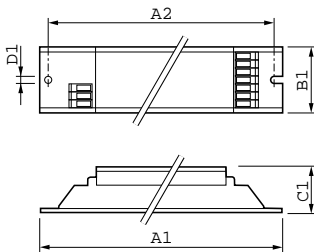

HF-P Xt 254 TL5 EII 220-240V 50/60Hz

Product	D1	C1	A1	A2	B1
HF-P Xt 254 TL5 EII 220-240V 50/60Hz	4.2 mm	28.0 mm	360.0 mm	350.0 mm	30.0 mm

## HF-Performer II Xtreme for TL5/TL-D lamps

